

## About This Property

The Forty Caves conservation area includes lands owned by the Town of Berlin, the Town of Clinton, and SVT. In 2017, after each town purchased a portion of the forest that spans the town line, all of these lands were grouped into the cooperatively managed Forty Caves conservation area. Included in this group is the SVT property formerly known as Garfield Woods.

## Features of Note

- The Forty Caves conservation area protects habitat for two endangered species: Blanding's turtle and marbled salamander.
- North Brook rattles and gurgles beside you along the trail as it slips under a flat slab of rock. It finally widens into a quiet pool with banks that invite a picnic stop, as the brook continues onto the Assabet River.
- You'll notice steep drops alongside the trail. A view from the orange trail near Allen Road looks down toward the namesake of the conservation area—caves created by tumbled boulders and rock slabs that lean together.
- The Clinton-Newbury fault is visible at several points. The rock is tightly folded and crinkly, different from the granite gneiss found elsewhere in the conservation area.
- Local legend holds that the smooth, round depressions in the rock at Forty Caves once held quartz that Native Americans used for spear points. They popped the quartz nodules out of the surrounding rock with a combination of heat and cold.

**Learn more:**

[www.svtweb.org/FortyCaves](http://www.svtweb.org/FortyCaves)

## Trail Policies and Regulations

These policies apply to SVT properties on the map. Properties owned by other entities have their own posted policies.

The following are prohibited:

- Motorized vehicles
- Camping
- Bicycling
- Fires
- Disposing of trash or yard waste
- Cutting or removing plants



Dog walkers:

- Pick up and dispose of dog waste.
- Keep dogs on trails.
- Keep dogs out of ponds/streams/vernal pools.
- Put dogs on a leash when other hikers approach.

*See our full dog-walking policy on the trail head kiosk.*

## Directions

With mapping software, search for this address: Francis Street, Clinton, MA

From the intersection of Mechanic and Chestnut Streets in Clinton, proceed south on Chestnut Street 0.3 mile and turn left on Cameron Street. After 0.2 mile take a slight left on Oak Street. After 0.1 mile bear right onto Chace Street and proceed approximately 0.5 mile before turning right onto Francis Street. Turn right at the Forty Caves sign.

## Support SVT

SVT protects open spaces and natural areas in 36 communities around the Sudbury, Assabet, and Concord Rivers. We care for thousands of acres of land that provide habitat for native wildlife, and we maintain more than 60 miles of trails for public enjoyment.

With the financial support of our members, SVT is able to protect these lands forever.

**Be more than a guest! Be a member.**

[www.svtweb.org](http://www.svtweb.org)

## Forty Caves Trail Map



## BERLIN AND CLINTON

*This map includes trails that cross properties owned and maintained by the Town of Berlin and the Town of Clinton.*



18 Wolbach Road  
Sudbury, MA 01776-2429  
978-443-5588

[www.svtweb.org](http://www.svtweb.org)

Facebook: @SudburyValleyTrust

Twitter: @TweetSVT

Instagram: sudbury\_valley\_trustees

# Forty Caves, Berlin and Clinton

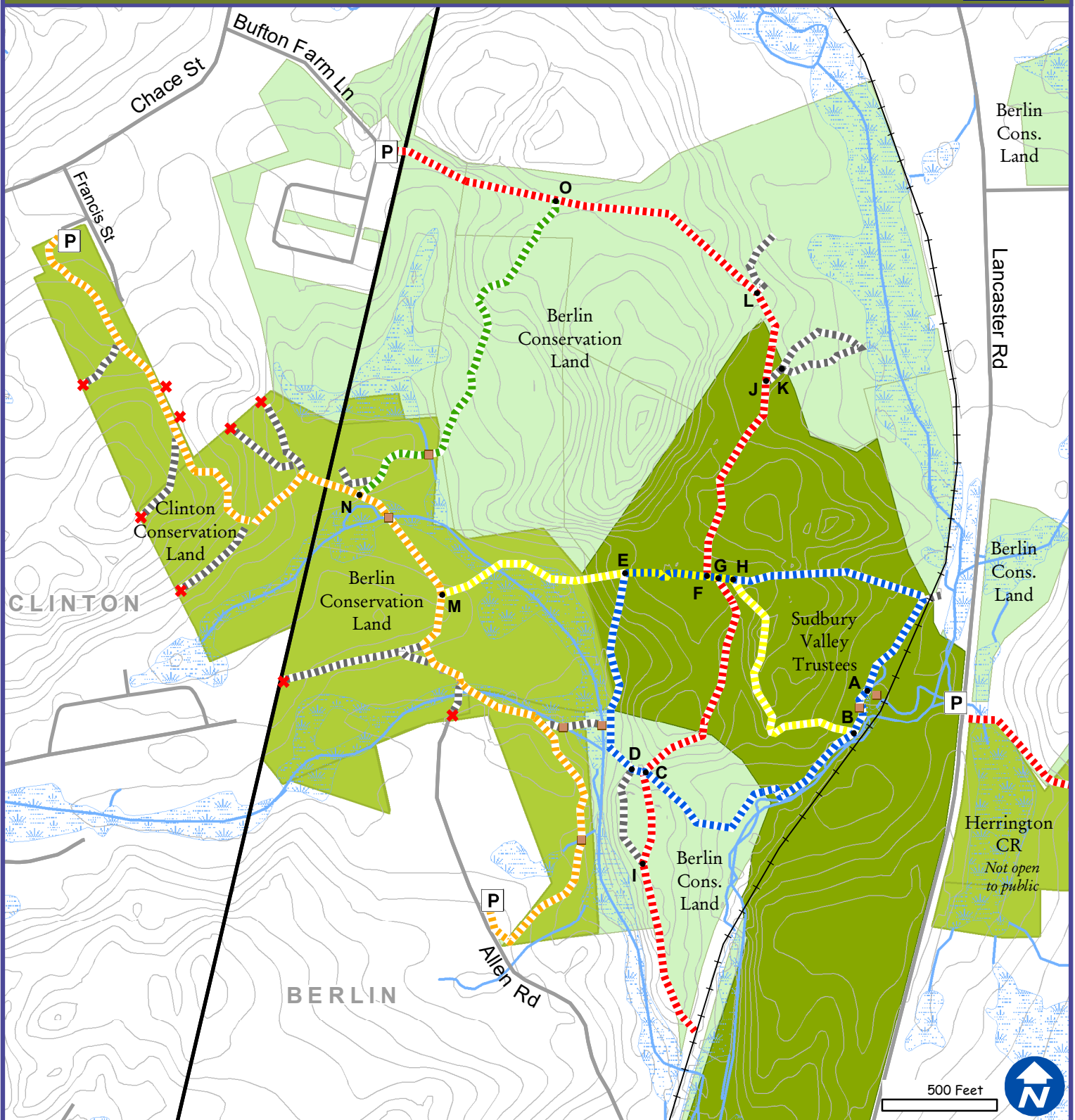

- |                  |            |                         |
|------------------|------------|-------------------------|
| <b>P</b> Parking | Trail      | SVT CR                  |
| Bridge           | Water Body | SVT Reservation         |
| Private          | Wetland    | Other Conservation Land |



How to  
Get Here  
(Berlin)



How to  
Get Here  
(Clinton)

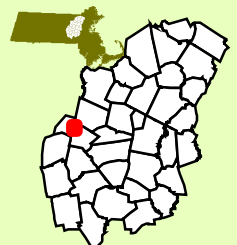

Map produced by Sudbury Valley Trustees.  
Data Provided by Office of Geographic and Environmental Information (MassGIS), Commonwealth of Massachusetts  
Executive Office of Energy and Environmental Affairs.

This Map should be used for reference only. Boundary lines are approximate.