



## About This Property

Owned by the Town of Bedford, the O'Connor land contains wooded uplands and wetlands, and it lies within a region that holds residential, industrial, and conservation lands. The trail system provides a much-needed place for respite and exercise in the midst of a heavily developed area.

SVT holds a conservation restriction (CR) on the property, which ensures it will never be developed into housing lots. SVT works with the Town of Bedford to ensure that the conservation values on the land are maintained.

In addition to the trail access at the parking area, it is also possible to enter the trails slightly north of 457 Old Billerica Road and behind 10 Noreen Drive in Bedford.

## Features of Note

- The property's primary use is for conservation and passive recreation. Horseback riding is permitted on the trails.
- The land includes habitat for the blue-spotted salamander, a species of special concern in Massachusetts.
- The southern trail connects to a trail on the Bedford Woods CR, which is maintained by the Town of Bedford.
- The property lies in close proximity to the Town of Bedford's Shawsheen River Conservation Area to the south and Fortune Drive Conservation Area to the north.

**Learn more:**

[www.svtweb.org/OConnorCR](http://www.svtweb.org/OConnorCR)



## Trail Policies and Regulations

These policies apply to SVT properties on the map. Properties owned by other entities have their own posted policies.

The following are prohibited:

- Motorized vehicles
- Hunting or trapping
- Camping
- Bicycling
- Fires
- Disposing of trash or yard waste
- Cutting or removing plants



Dog walkers:

- Pick up and dispose of dog waste.
- Keep dogs on trails.
- Keep dogs out of ponds/streams/vernal pools.
- Put dogs on a leash when other hikers approach.

*See our full dog-walking policy on the trail head kiosk.*

## Directions

With mapping software, search for this address:  
463 Old Billerica Road, Bedford, MA

From Route 3 in Bedford, take Exit 26. Follow Route 62 west toward Bedford for approximately 0.7 mile. Turn right onto Old Billerica Road. Go 1.7 miles. Turn right onto a very narrow access road (driveway) between two house lots. Number 463 is marked on a stone wall at the entrance to access the road. Go 200 feet to the parking area.

## Support SVT

SVT protects open spaces and natural areas in 36 communities around the Sudbury, Assabet, and Concord Rivers. We care for thousands of acres of land that provide habitat for native wildlife, and we maintain more than 60 miles of trails for public enjoyment.

SVT relies upon the support of our members to be successful.

**Join Us! Help protect these lands forever.**

[www.svtweb.org](http://www.svtweb.org)

# O'Connor Conservation Restriction Trail Map



## BEDFORD

*This map includes trails that cross properties owned and maintained by the Town of Bedford.*



18 Wolbach Road  
Sudbury, MA 01776-2429  
978-443-5588

[www.svtweb.org](http://www.svtweb.org)

Facebook: @SudburyValleyTrust

Twitter: @TweetSVT

Instagram: sudbury\_valley\_trustees

# O'CONNOR CR, BEDFORD

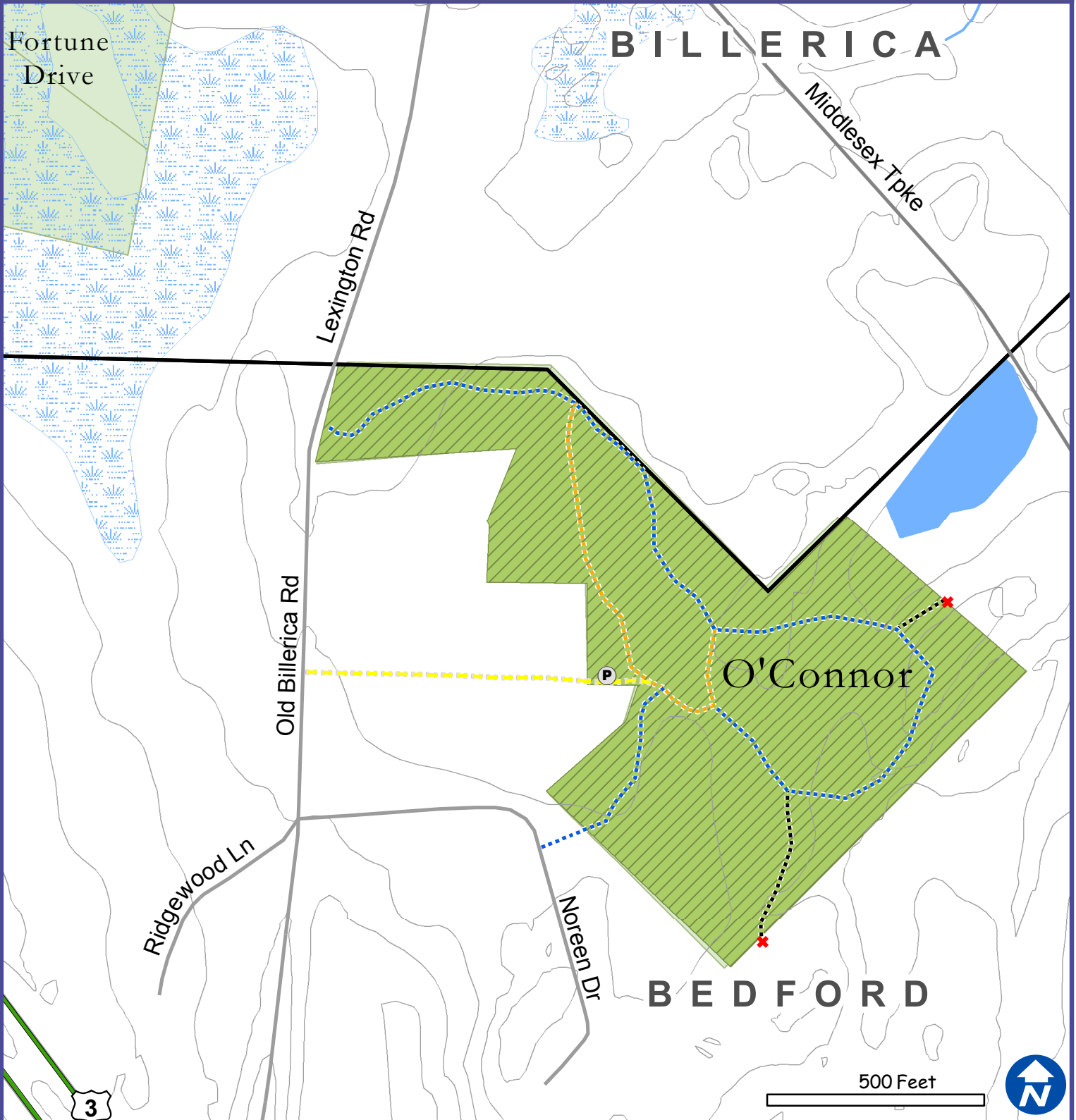

- P Parking
- - - - - Trail
- Water Body
- Road
- SVT CR
- Bridge
- x Private
- Wetland
- SVT
- Other Owner



How to Get Here

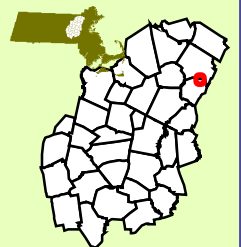

## Love open spaces? Support SVT!

Sudbury Valley Trustees is a nonprofit conservation organization that protects land for the benefit of people and wildlife. Help us keep these trails open for all to enjoy. **Join or Donate today! [www.svtweb.org](http://www.svtweb.org)**