



About This Property

The Hamlen Woods tract encompasses open water, swamp, upland forest, and the headwaters of Snake Brook, which is fed by a series of springs and draining from the wetlands. An hour's comfortable ramble through tranquil forest includes an intriguing transit of an old reservoir with plentiful evidence of beaver activity.

Your hike can be extended to Mainstone Farm and by crossing Rice Road to Town of Wayland conservation land, including a climb to the hidden summit of Turkey Hill.

Please note that Mainstone Farm is privately owned. Portions of the land are not open to the public. Please stay on designated trails, shown on the map.

Features of Note

- Outstanding natural features include many outcroppings of bedrock, mostly Westborough Quartzite, and a kettle hole formed by a glacier.
- Stone walls provide evidence of earlier pastures, as do large cedar trees.
- The ponds that greet you near the Hamlen Woods parking area on Rice Road were created when Snake Brook was dammed, initially to create Rice's Pond.
- Trails are marked with colored diamond-shaped signs, indicated by the corresponding colored lines on the map.
- The blue trail will lead you from the Hamlen Woods parking area, north to Reeves Hill Conservation Land, over a one-way route of approximately 1.75 miles.
- The red trail will take you on an approximately 4.5-mile circuit through all of the connected areas. Use caution while walking on Rice Road if you plan to link your walk between the Mainstone Farm parking area and Turkey Hill Road.

Learn more:
www.svtweb.org/HamlenWoods



Trail Policies and Regulations

These policies apply to SVT properties on the map. Properties owned by other entities have their own posted policies.

The following are prohibited:

- Motorized vehicles
- Hunting or trapping
- Camping
- Bicycling
- Fires
- Disposing of trash or yard waste
- Cutting or removing plants



Dog walkers:

- Pick up and dispose of dog waste.
- Keep dogs on trails.
- Keep dogs out of ponds/streams/vernal pools.
- Put dogs on a leash when other hikers approach.

See our full dog-walking policy on the trail head kiosk.

Directions

With mapping software, search for this address:
194 Rice Road, Wayland, MA

From the intersection of Route 20 and Routes 126/27 in Wayland, go east on Route 20 for 1.3 mi. Turn sharp right on Old Connecticut Path. Go 0.5 mile and turn left on Rice Road. Go 0.6 miles to a parking lot on your right. The lot is marked with a "Mainstone Farm Trails" sign.

Support SVT

SVT protects open spaces and natural areas in 36 communities around the Sudbury, Assabet, and Concord Rivers. We care for thousands of acres of land that provide habitat for native wildlife, and we maintain more than 60 miles of trails for public enjoyment.

SVT relies upon the support of our members to be successful.

Join Us! Help protect these lands forever.
www.svtweb.org

Hamlen Woods and Mainstone Farm CR Trail Map



WAYLAND

This map includes trails that cross properties owned and maintained by the Town of Wayland and private landowners.



18 Wolbach Road
Sudbury, MA 01776-2429
978-443-5588
www.svtweb.org
Facebook: @SudburyValleyTrust
Twitter: @TweetSVT
Instagram: sudbury_valley_trustees

MAINSTONE FARM & HAMLEN WOODS

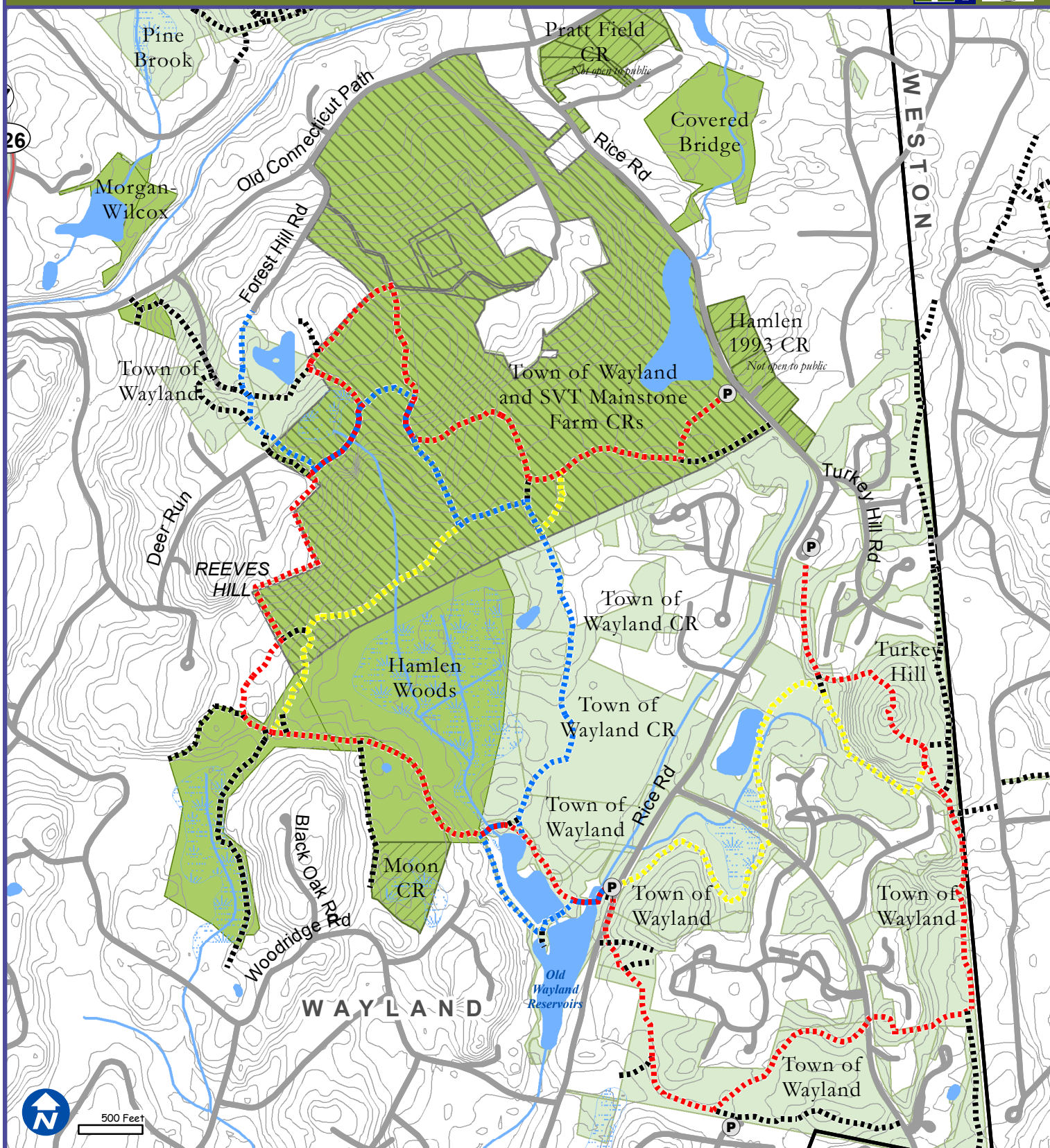

- Parking
- Water Body
- SVT
- Mainstone Farm
- Red Trail
- Blue Trail
- SVT CR
- Town of Wayland
- Yellow Trail
- Unmarked Trail
- Road
- Wetland



How to
Get Here

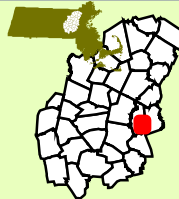

Love open spaces? Support SVT!

Sudbury Valley Trustees is a nonprofit conservation organization that protects land for the benefit of people and wildlife. Help us keep these trails open for all to enjoy. **Join or Donate today! www.svtweb.org**

Map produced by Sudbury Valley Trustees. Data Provided by Office of Geographic and Environmental Information (MassGIS), Commonwealth of Massachusetts Executive Office of Energy and Environmental Affairs. This Map should be used for reference only. Boundary lines are approximate.